



**HASLINGER**  
RETAIL REAL ESTATE CONSULTING

**HASLINGER**  
MANAGEMENT



**HUMA**  
OUTLET

OPEN SINCE 21 NOV 2024

JUNE 2026

# HUMA Erfolgsmodell Hybrid

## Proven Hybrid Success Story

2

**9,000m<sup>2</sup>**

OUTLET SALES AREA

**50,000m<sup>2</sup>**

TOTAL SALES AREA

**5.6M**

VISITORS PER YEAR

**40**

OUTLET STORES

**130**

TOTAL STORES

**2,300**

PARKING SPACES

**KÖLN/BONN**

REGION

**21 NOV 2024**

OPENING

**> 50 YEARS**

TRADITION

**> 6M**

TOURISTS PER YEAR



# HUMA | Das Center der Region

## HUMA | The Centre of the Region

3



A3 · A59 · A560 · B56 | BUS & TRAIN DIRECTLY AT MAIN ENTRANCE | 2,300 PARKING SPACES

# Große Markenvielfalt

## Large Brand Diversity

**TOP BRANDS  
COME TOGETHER**

SCHIESSER G-STAR  
 Marc O'Polo G·K·MAYER  
 TOMMY HILFIGER  
 SEOUL EDITION W MF FYNCH HATTON SALEWA  
 CECIL Tefal amor  
 Street One  
 CEP MÖKE GERMANY 1927  
 bugatti TOM TAILOR  
 ITEM m6 Lindt  
 Ravensburger RÖSLE SINCE 1888 MUSTANG®  
 GUESS WELLENSTEYN Petrel  
 bruno banani.  
 Blue Brixx LLOYD





# HUMA AUF DREI EBENEN

## HUMA ON THREE LEVELS

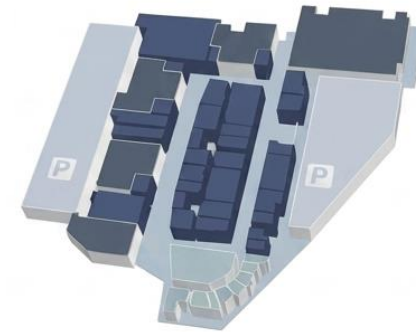

### UPPER FLOOR

- Outlet
- Food

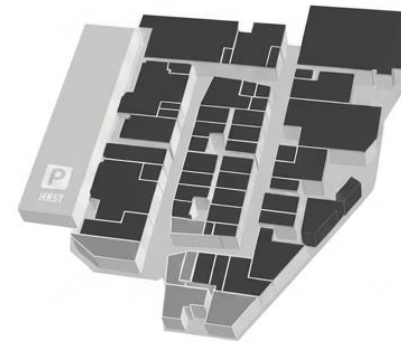

### FIRST FLOOR

- Shopping
- Food

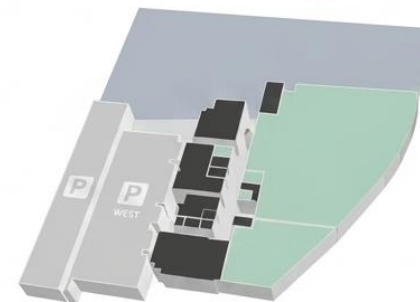

### GROUND FLOOR

- Shopping
- Food

# OUTLET UPPER LEVEL

- IN NEGOTIATION
- ISH
- SENT OUT FOR SIGNATURE
- SIGNED
- TRADING



New Yorker (Bestandsmieter)  
Aufteilung voraussichtlich 2027

25 Jun 2026

Only internal use!  
Please keep it high confidential!

# HUMA Frequenz pro Woche

HUMA Frequency per week

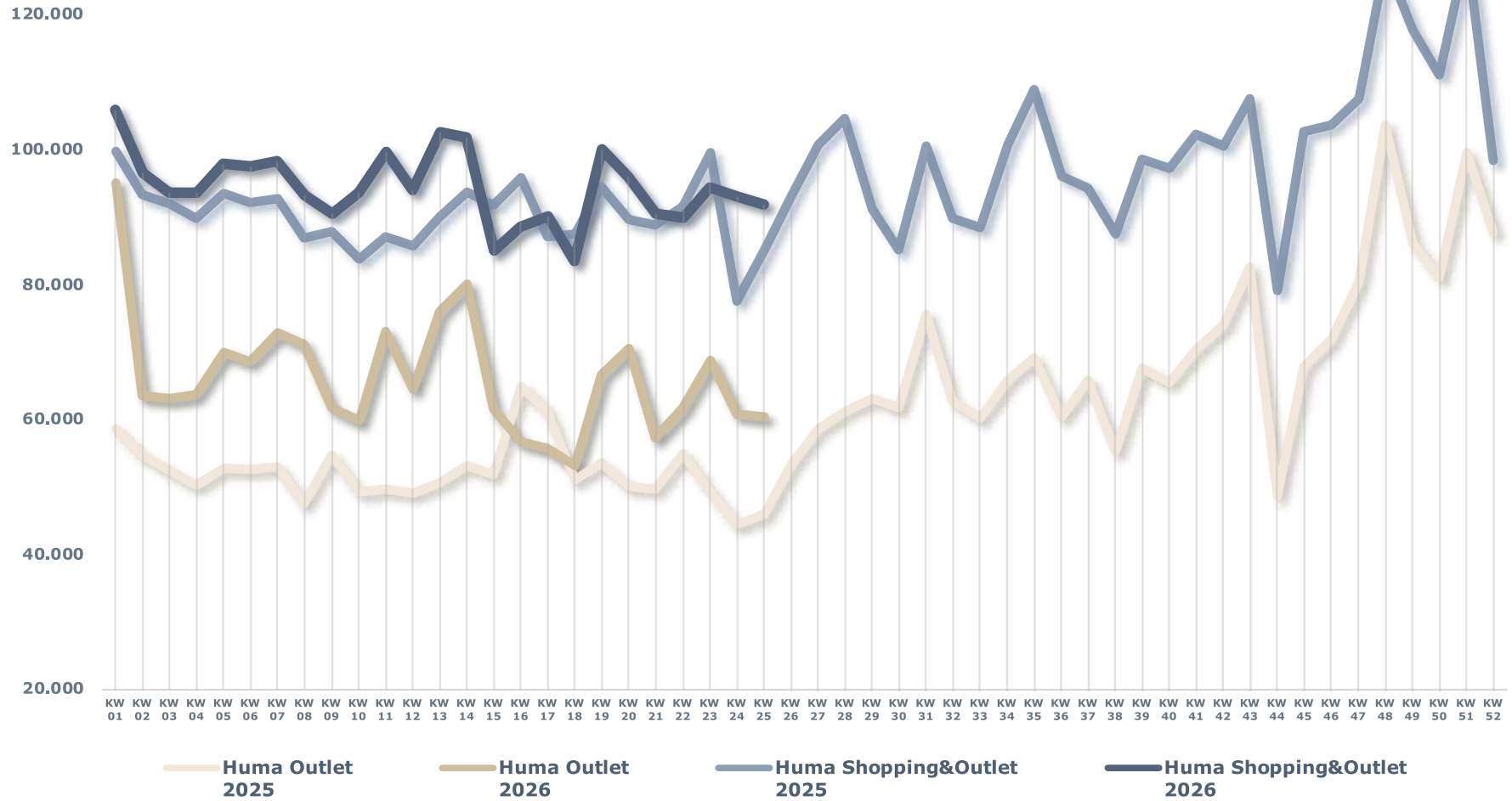

# HUMA Outlet Performance

## HUMA Outlet Performance

FREQUENCY 2025 / 2026

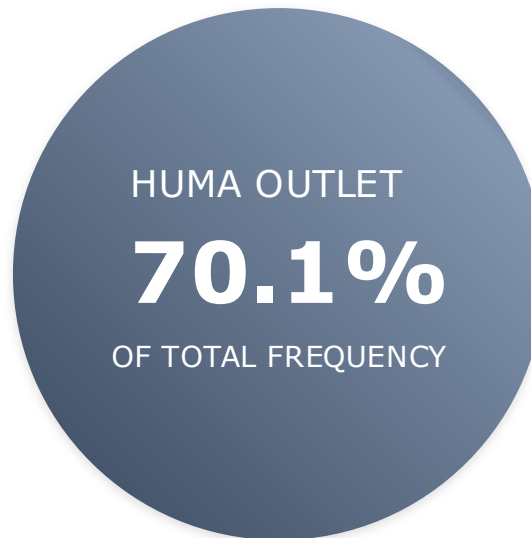

Starker Aufwärtstrend. Kontinuierlich steigend.  
Strong upward trend. Growing since opening.



OUTLET  
OPENING

NOV  
2024



FREQUENCY

3.2M  
OUTLET

5.6M  
OUTLET & SHOPPING



RETAIL

40  
STORES OUTLET

9,000m<sup>2</sup>  
SALES AREA OUTLET

130  
STORES OUTLET & SHOPPING

50,000m<sup>2</sup>  
SALES AREA OUTLET & SHOPPING



PARKING

2,300  
PARKING SPACES



GUESS  
OUTLET

OUTLET

GUESS

Marc O'Polo  
EST. IN STOCKHOLM  
OUTLET

Marc O'Polo  
EST. IN STOCKHOLM  
OUTLET

Marc O'Polo  
EST. IN STOCKHOLM  
OUTLET









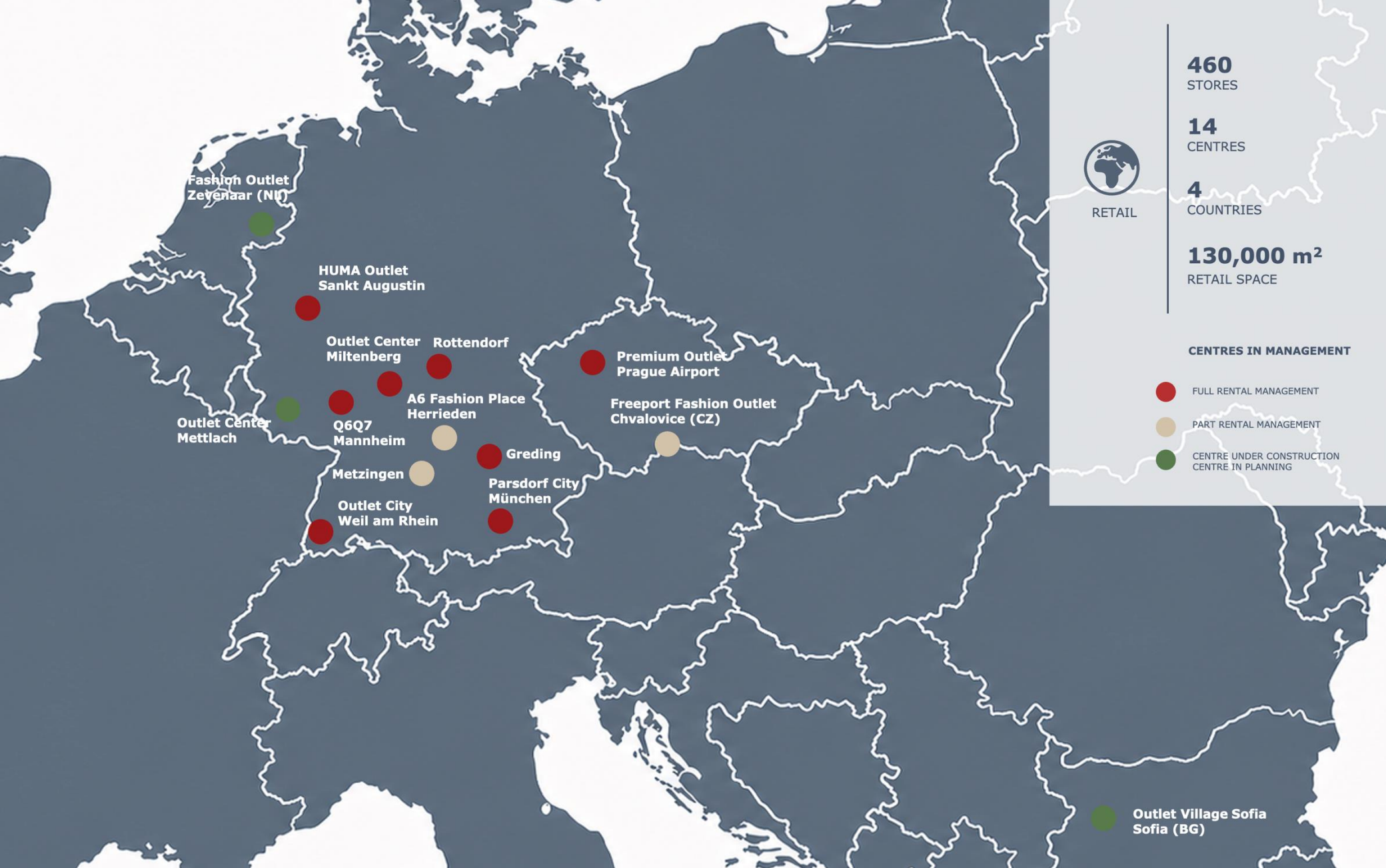

# OUR CENTRES



**HUMA**  
OUTLET



**OUTLET CITY**  
WEIL AM RHEIN



**fashion  
outlet  
zevenaar**



**FREEPORT**  
FASHION OUTLET



DAS QUARTIER

**MILTENBERGER**  
OUTLET // CENTER



**OUTLET**  
VILLAGE  
— SOFIA —

**POP**   
OUTLET & ENTERTAINMENT

# OUR REFERENCES

*Stadtgalerie Plauen • Rotmain Center Bayreuth • Franken Center Nürnberg • City Point Nürnberg • Stadtgalerie Heilbronn • Leo Center Leonberg • Saarpark Center Neunkirchen • Europa-Galerie Saarbrücken • The Colosseum Bucharest, RO • Drei Glocken Center Weinheim • Das Gerber Stuttgart • Designer Outlet Neumünster • Designer Outlet Berlin • Designer Outlet Roermond, NL • Designer Outlet Salzburg, AT • Designer Outlet Parndorf, AT • Designer Outlet Landquart, CH • Designer Outlet Soltau • Parndorf Fashion Outlet, AT • Outlet Center Brenner, IT • Outlet Noyon-Allee Metzingen • Galizia Center Metzingen • Outlet Center Moravia, CZ • Freeport, CZ • Outlet Center Hammerau • Outlet Center Drei Länder Galerie • Outlet Center Echternach, LU • Outlet Center Egelsbach Frankfurt a.M. • Outlet Center Jettingen-Scheppach • Klagefurt Outlets • Outlet Berlin Wustermark • Outlet Center Selb • Outlet Center Wadgassen • City Outlet Rietberg • City Outlet Dinkelsbühl • City Outlet Rüsselsheim • City Outlet Zwiesel • City Outlet Wernigerode • City Outlet Bad Münstereifel • Mustang • CBR Street One Cecil • Barutti • René Lezard • Le Creuset • Estée Lauder MAC Cosmetics • Apple mcworld, AT • LTB Jeans, TR • White Stuff, UK*



TOMMY HILFINGER



ZARA HOME

GANT



BETTY BARCLAY



BRAX



OLYMP

LIEBESKIND  
BERLIN



Marc O'Polo® Deazigual®

GUESS

comma



s.Oliver



CECIL

Street One

CALVIN KLEIN



Massimo Dutti



seidensticker



ONLY



eCCO



TOM TAILOR



bruno banani  
NOT FOR EVERYBODY



hunkemöller

JACK&JONES

bugatti



SCHIESSER

carhartt  
WORK IN PROGRESS



CLOSED

G-STAR

MUSTANG®



PANDORA

swatch



DOUGLAS

L'ORÉAL  
PARIS

MAC

PORSCHE DESIGN

möVE



Villeroy & Boch  
1748

Tefal



Lindt  
MAÎTRE CHOCOLATIER SUISSE  
DEPUIS 1845

HARIBO





**MICHAEL  
HASLINGER**

CHAIRMAN OF THE BOARD

+49 172 83 68 297

m.haslinger@haslinger-immobilien.de



**KLAUS  
PREKER**

LEASING MANAGER  
& EXECUTIVE SEARCH

+49 151 465 36 845

k.preker@haslinger-immobilien.de



**NABILA  
GREMMINGER**

LEASING EXECUTIVE  
& SECRETARY

+49 176 5611 4390

n.gremminger@haslinger-immobilien.de



**SABINE  
HASLINGER**

FINANCE MANAGER

+49 172 21 28 409

sh@haslinger-immobilien.de



**EVELIN  
TOPCU**

MARKETING & IT/AI  
PROCESS MANAGER

+49 172 35 56 805

e.topcu@haslinger-immobilien.de



**MATTHIAS  
DÜRR**

DIRECTOR  
RETAIL & MARKETING

+49 177 77 32 222

m.duerr@haslinger-management.de



**ESENGÜL  
KAHRAMAN**

RETAIL MANAGER

+49 155 61 69 44 14

e.kahraman@haslinger-management.de



**PETER  
KULAWIAK**

CONTENT MARKETING  
CREATOR

+49 155 61 93 03 38

p.kulawiak@haslinger-management.de



**LOUISA  
SCORY**

MARKETING MANAGER

+49 155 61 36 32 66

l.scory@haslinger-management.de



**ISABELLE  
SUDMANN**

MARKETING ASSISTANT

+49 155 62 47 77 54

i.sudmann@haslinger-management.de

# URHEBERRECHT & COPYRIGHT

Der Inhalt dieser Präsentation darf nicht reproduziert, verarbeitet oder verbreitet werden.

Die Inhalte sind ausschließlich für interne Zwecke bestimmt, Veröffentlichung ist eindeutig untersagt.

Die Weitergabe der Präsentationsinhalte bedarf einer schriftlichen Zustimmung von HASLINGER RETAIL REAL ESTATE CONSULTING.

The entire content of this presentation may not be reproduced, processed or distributed.

The contents are intended for internal use only, publication is strictly prohibited.

Passing on the contents of the presentation requires the written consent of HASLINGER RETAIL REAL ESTATE CONSULTING.

# HASLINGER

RETAIL REAL ESTATE CONSULTING

*Successfully in business for over 10 years!*

# HASLINGER

MANAGEMENT