



HASLINGER
RETAIL REAL ESTATE CONSULTING

HASLINGER
MANAGEMENT



HUMA
OUTLET

OPEN SINCE 21 NOV 2024

JUNE 2026

HUMA Erfolgsmodell Hybrid

Proven Hybrid Success Story

2

9,000m²

OUTLET SALES AREA

50,000m²

TOTAL SALES AREA

5.6M

VISITORS PER YEAR

40

OUTLET STORES

130

TOTAL STORES

2,300

PARKING SPACES

KÖLN/BONN

REGION

21 NOV 2024

OPENING

> 50 YEARS

TRADITION

> 6M

TOURISTS PER YEAR



HUMA | Das Center der Region

HUMA | The Centre of the Region

3



A3 · A59 · A560 · B56 | BUS & TRAIN DIRECTLY AT MAIN ENTRANCE | 2,300 PARKING SPACES

Große Markenvielfalt

Large Brand Diversity

**TOP BRANDS
COME TOGETHER**

SCHIESSER G-STAR
 Marc O'Polo G·K·MAYER
 TOMMY HILFIGER
 SEOUL EDITION W MF FYNCH HATTON SALEWA
 CECIL Tefal amor
 Street One
 CEP MÖKE GERMANY 1927
 bugatti TOM TAILOR
 ITEM m6 Lindt
 Ravensburger RÖSLE SINCE 1888 MUSTANG®
 GUESS WELLENSTEYN Petrel
 Blue Brixx bruno banani. NOT FOR EVERYBODY
 LLOYD





HUMA AUF DREI EBENEN

HUMA ON THREE LEVELS

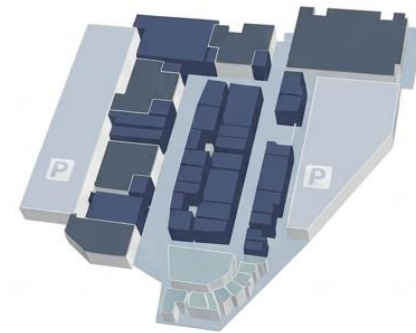

UPPER FLOOR

- Outlet
- Food

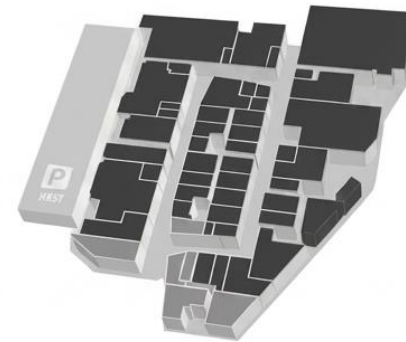

FIRST FLOOR

- Shopping
- Food

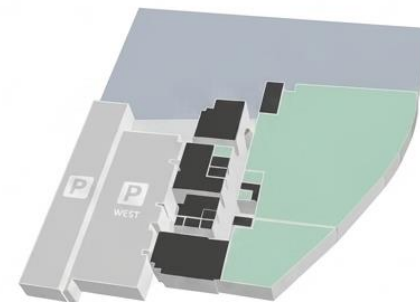

GROUND FLOOR

- Shopping
- Food

HUMA Frequenz pro Woche

HUMA Frequency per week

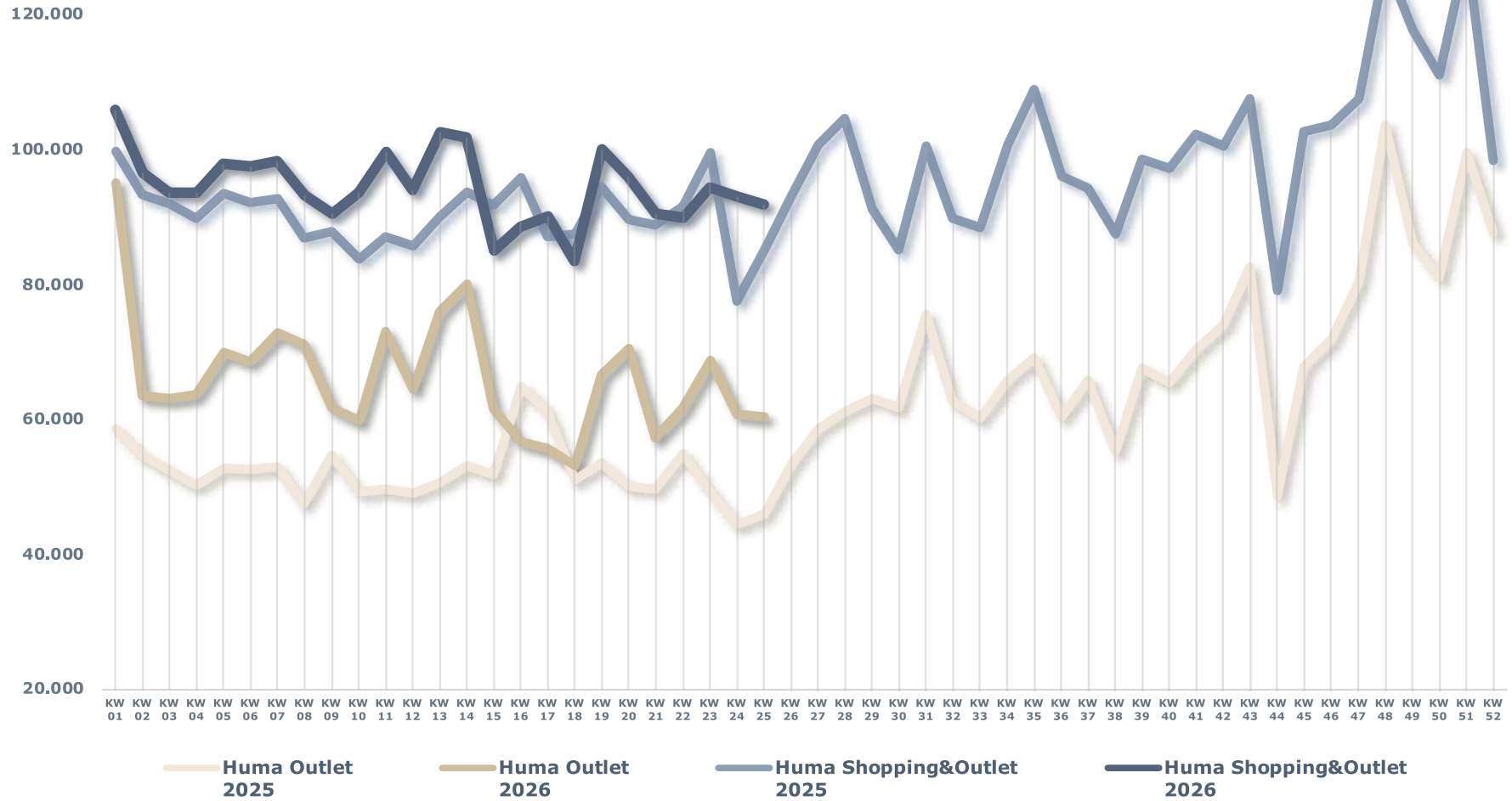

HUMA Outlet Performance

HUMA Outlet Performance

FREQUENCY 2025 / 2026

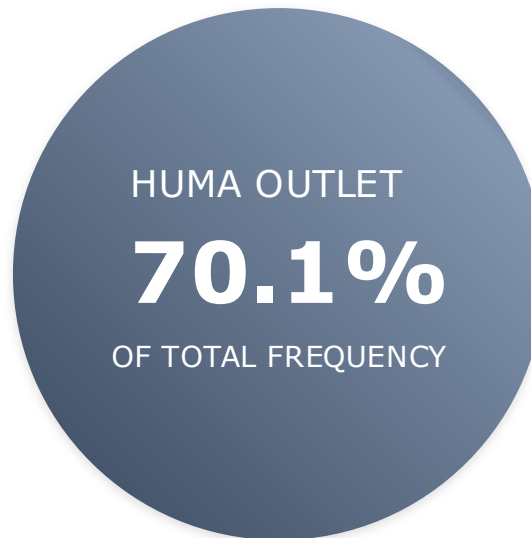

Starker Aufwärtstrend. Kontinuierlich steigend.
Strong upward trend. Growing since opening.



OUTLET
OPENING

NOV
2024



FREQUENCY

3.2M
OUTLET

5.6M
OUTLET & SHOPPING



RETAIL

40
STORES OUTLET

9,000m²
SALES AREA OUTLET

130
STORES OUTLET & SHOPPING

50,000m²
SALES AREA OUTLET & SHOPPING



PARKING

2,300
PARKING SPACES





GUESS
OUTLET

OUTLET

GUESS

GUESS

GUESS

Marc O'Polo
EST. IN STOCKHOLM
OUTLET

Marc O'Polo
EST. IN STOCKHOLM
OUTLET

Marc O'Polo
EST. IN STOCKHOLM
OUTLET

Marc O'Polo









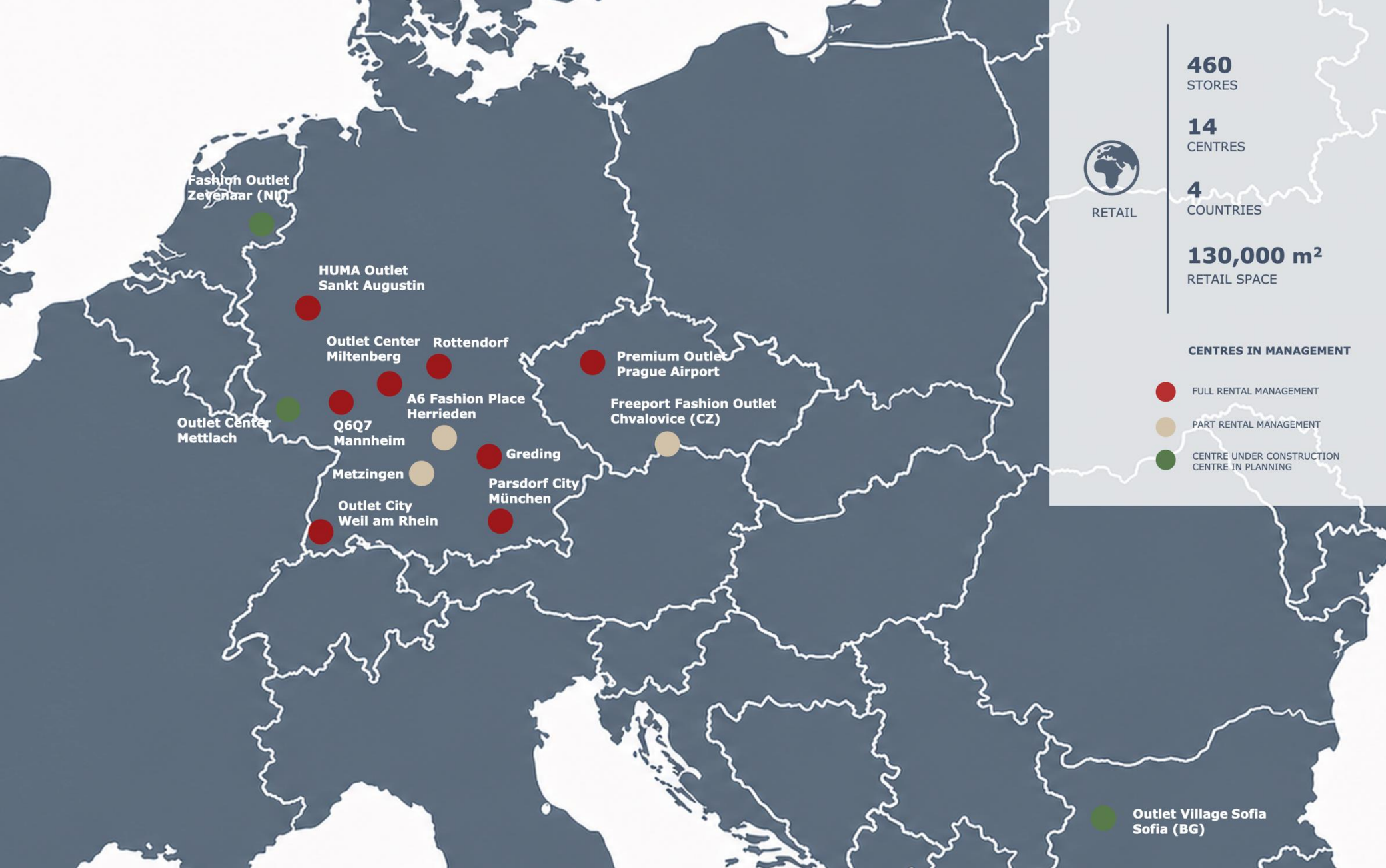

RETAIL

OUR CENTRES



HUMA
OUTLET



OUTLET CITY
WEIL AM RHEIN



**fashion
outlet**
zevenaar



FREEPORT
FASHION OUTLET



Q 6 Q 7
Mannheim

DAS QUARTIER

MILTENBERGER
OUTLET // CENTER



OUTLET
VILLAGE
— SOFIA —

POP 
OUTLET & ENTERTAINMENT

OUR REFERENCES

Stadtgalerie Plauen • Rotmain Center Bayreuth • Franken Center Nürnberg • City Point Nürnberg • Stadtgalerie Heilbronn • Leo Center Leonberg • Saarpark Center Neunkirchen • Europa-Galerie Saarbrücken • The Colosseum Bucharest, RO • Drei Glocken Center Weinheim • Das Gerber Stuttgart • Designer Outlet Neumünster • Designer Outlet Berlin • Designer Outlet Roermond, NL • Designer Outlet Salzburg, AT • Designer Outlet Parndorf, AT • Designer Outlet Landquart, CH • Designer Outlet Soltau • Parndorf Fashion Outlet, AT • Outlet Center Brenner, IT • Outlet Noyon-Allee Metzingen • Galizia Center Metzingen • Outlet Center Moravia, CZ • Freeport, CZ • Outlet Center Hammerau • Outlet Center Drei Länder Galerie • Outlet Center Echternach, LU • Outlet Center Egelsbach Frankfurt a.M. • Outlet Center Jettingen-Scheppach • Klagefurt Outlets • Outlet Berlin Wustermark • Outlet Center Selb • Outlet Center Wadgassen • City Outlet Rietberg • City Outlet Dinkelsbühl • City Outlet Rüsselsheim • City Outlet Zwiesel • City Outlet Wernigerode • City Outlet Bad Münstereifel • Mustang • CBR Street One Cecil • Barutti • René Lezard • Le Creuset • Estée Lauder MAC Cosmetics • Apple mcworld, AT • LTB Jeans, TR • White Stuff, UK





**MICHAEL
HASLINGER**

CHAIRMAN OF THE BOARD

+49 172 83 68 297

m.haslinger@haslinger-immobilien.de



**KLAUS
PREKER**

LEASING MANAGER
& EXECUTIVE SEARCH

+49 151 465 36 845

k.preker@haslinger-immobilien.de



**NABILA
GREMMINGER**

LEASING EXECUTIVE
& SECRETARY

+49 176 5611 4390

n.gremminger@haslinger-immobilien.de



**SABINE
HASLINGER**

FINANCE MANAGER

+49 172 21 28 409

sh@haslinger-immobilien.de



**EVELIN
TOPCU**

MARKETING & IT/AI
PROCESS MANAGER

+49 172 35 56 805

e.topcu@haslinger-immobilien.de



**MATTHIAS
DÜRR**

DIRECTOR
RETAIL & MARKETING

+49 177 77 32 222

m.duerr@haslinger-management.de



**ESENGÜL
KAHRAMAN**

RETAIL MANAGER

+49 155 61 69 44 14

e.kahraman@haslinger-management.de



**PETER
KULAWIAK**

CONTENT MARKETING
CREATOR

+49 155 61 93 03 38

p.kulawiak@haslinger-management.de



**LOUISA
SCORY**

MARKETING MANAGER

+49 155 61 36 32 66

l.scory@haslinger-management.de



**ISABELLE
SUDMANN**

MARKETING ASSISTANT

+49 155 62 47 77 54

i.sudmann@haslinger-management.de

URHEBERRECHT & COPYRIGHT

Der Inhalt dieser Präsentation darf nicht reproduziert, verarbeitet oder verbreitet werden.

Die Inhalte sind ausschließlich für interne Zwecke bestimmt, Veröffentlichung ist eindeutig untersagt.

Die Weitergabe der Präsentationsinhalte bedarf einer schriftlichen Zustimmung von HASLINGER RETAIL REAL ESTATE CONSULTING.

The entire content of this presentation may not be reproduced, processed or distributed.

The contents are intended for internal use only, publication is strictly prohibited.

Passing on the contents of the presentation requires the written consent of HASLINGER RETAIL REAL ESTATE CONSULTING.

HASLINGER

RETAIL REAL ESTATE CONSULTING

Successfully in business for over 10 years!

HASLINGER

MANAGEMENT