

**HASLINGER**  
RETAIL REAL ESTATE CONSULTING

**HASLINGER**  
MANAGEMENT



July 2025



## Proven successful partners in **Outlet projects**

Fashion Outlet Zevenaar is being developed by highly experienced professionals, STABLE International and Veluwezoom Verkerk, a VolkerWessels company. STABLE International is more than just a developer; the company also sourced the management teams and handled the leases on these successful centres.

Leasing and management for Fashion Outlet Zevenaar will be handled by the experienced and professional STABLE International team. Veluwezoom Verkerk is responsible for the construction of the project.

The outlet projects of STABLE:

- Batavia Stad Fashion Outlet
- Designer Outlet Roosendaal
- The Style Outlets Montabaur
- The Style Outlets Leipzig

VolkerWessels was partner in the development of the last phase of Designer Outlet Roermond





## The perfect stylish location

# Fashion Outlet Zevenaar

Soon a new outlet is to open in the Netherlands, close to the German border and directly off the new planned Zevenaar exit on the A12 motorway (as part of the extended German A3 Autobahn). Covering 19,400m<sup>2</sup>, the Fashion Outlet Zevenaar will be a luxurious and stylish development, boasting a variety of stores including 1,550m<sup>2</sup> dedicated to restaurants, as well as a supermarket directly opposite. In short, it is the perfect place for a day's shopping.

The architecture of the Fashion Outlet draws inspiration from Zevenaar and its surroundings. Distinctive buildings such as the De Panoven brick factory in Zevenaar, the historic Huis Aerdt in Herwen, the old market hall at Didam, elements from the Huize Babberich country house on the Halsaf estate and the Giesbeek pumping station will be brought together to create an atmospheric and high-quality design. When all of these elements are combined against the stunning backdrop of the location, it will truly be the ultimate shoppers' paradise.





# Fashion Outlet Zevenaar

Project: 19,400 m<sup>2</sup>

Shops: > 85 shops

Parking: 2,200 approx.

Restaurants: 1,550 m<sup>2</sup>

Supermarket: 1,350 m<sup>2</sup>

Stock: 1,000 m<sup>2</sup>

364 days open



# Optimal accessibility Perfect location

## Motorways

Centrally located along the busy commuter belt between the Netherlands and Germany, the site is easily accessible. Plans are in place for the crucial development of the access roads; the A15 from Rotterdam will be continued to join the A12 and both the A15 and the A12 are to be expanded to 2 x 3 lanes. With a parking capacity for more than 2,200 vehicles less than 2 minutes' drive from the motorway, visitors will be able to arrive and park with ease.

## Airports

The region is easily accessible for the international visitor. Zevenaar is approximately 60 minutes' drive from the international airports of Schiphol and Düsseldorf, and around 50 minutes from Weeze airport in Germany.

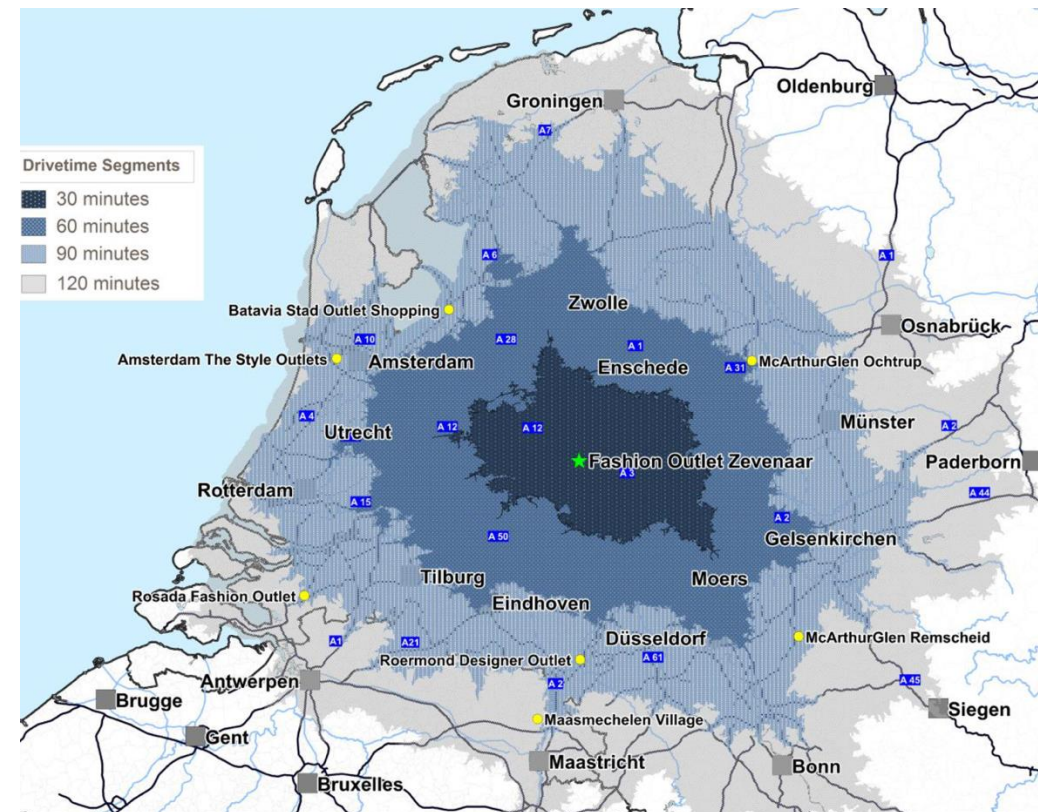

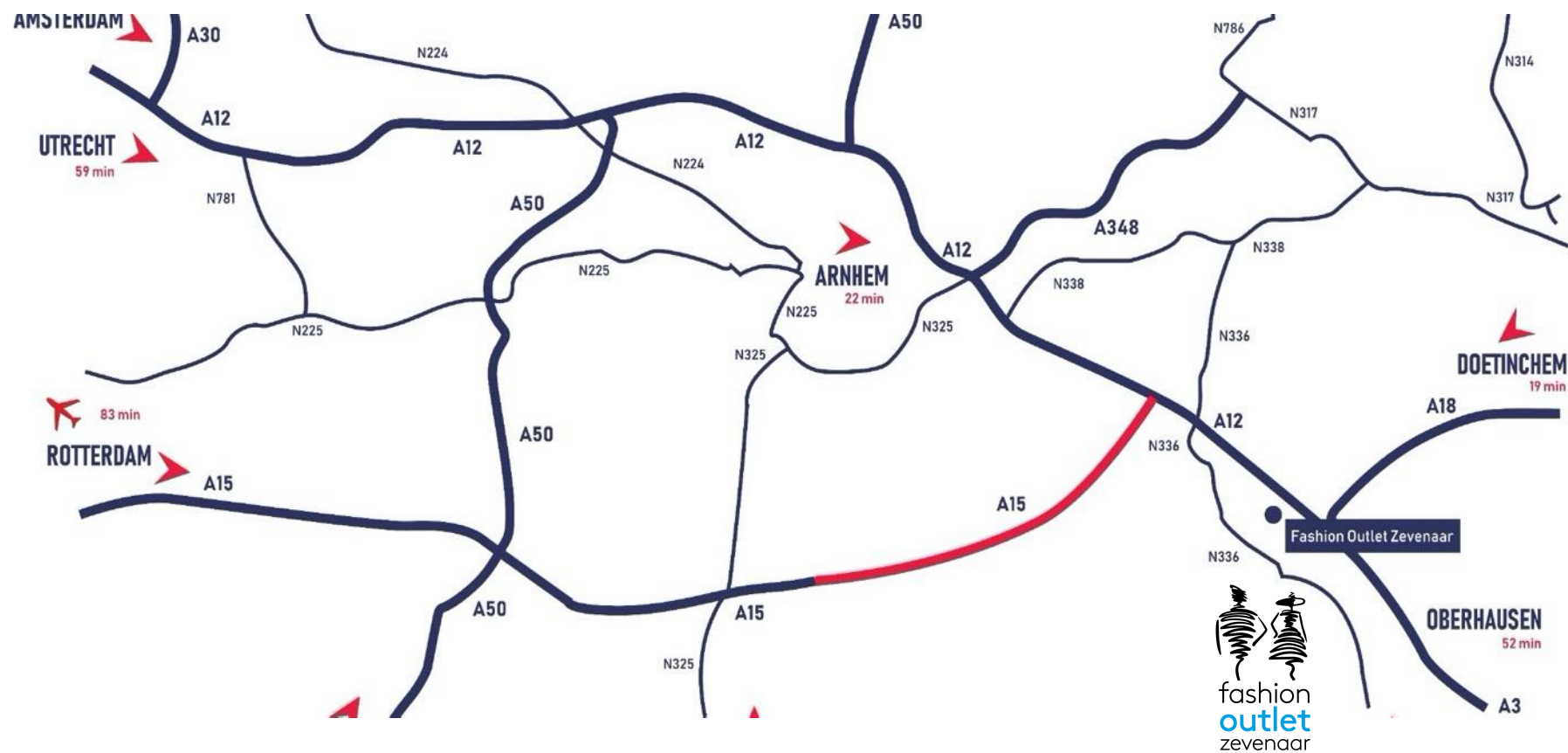



# The best outlet Catchment area

## Extremely impressive catchment area

Fashion Outlet Zevenaar is located in one of Europe's most densely populated areas with approximately **13 million people living within a 60 minute drive** time and **30 million within a 90 minute drive** time based on the construction of the A15 . The area is also a renowned tourist destination with 19 million overnight stays in 2018 – making this an ideal outlet centre location.

Catchment area 90 minutes  
**RANKING Fashion Outlet Zevenaar**  
**1st** vs. 211 existing European outlets schemes\*

*\* source: Research Pragma Consulting - London*



# Catchment areas of the Dutch Outlets

inhabitans

35,000,000

30,000,000

25,000,000

20,000,000

15,000,000

10,000,000

5,000,000

Fashion Outlet Zevenaar \*

30,000,000

Designer Outlet Roosendaal

18,000,000

The Style Outlets A'dam

Batavia Stad Fashion Outlet

Designer Outlet Roermond

20,100,000

12,800,000

5,200,000

12,130,000

10,800,000

17,200,000

10,770,000

12,000,000

6,400,000

4,100,000

400,000

2,000,000

1,700,000

Project:

Designer Outlet Roosendaal

The Style Outlets  
Amsterdam

Batavia Stad Fashion Outlet

Fashion Outlet Zevenaar

Designer Outlet Roermond

30 min 60 min 90 min Total

30 min 60 min Total

30 min 60 min 90 min Total

30 min 60 min 90 min Total

30 min 60 min 90 min Total

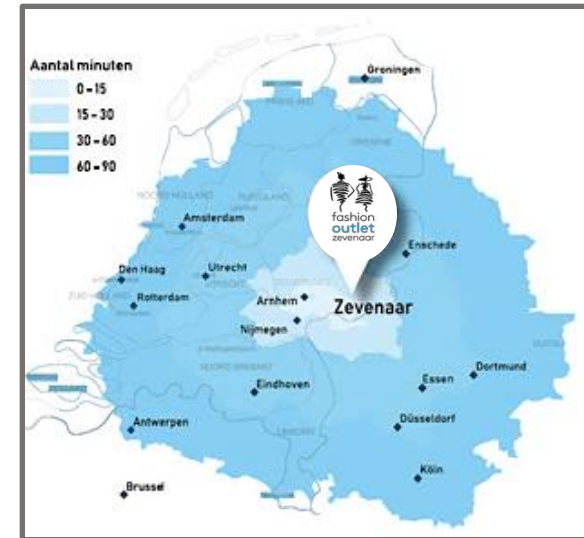

\*based on the new A15



ACCESSIBILITY:  
2 MIN. DRIVE FROM MOTORWAY \*

Note: the landscaping of the parking is indicative!

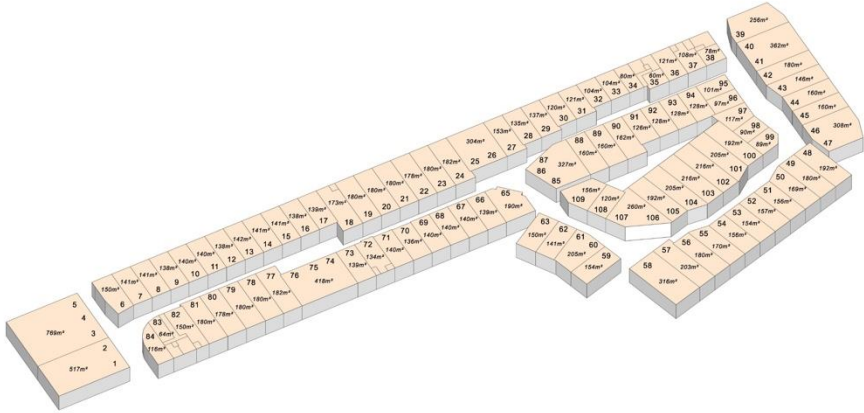
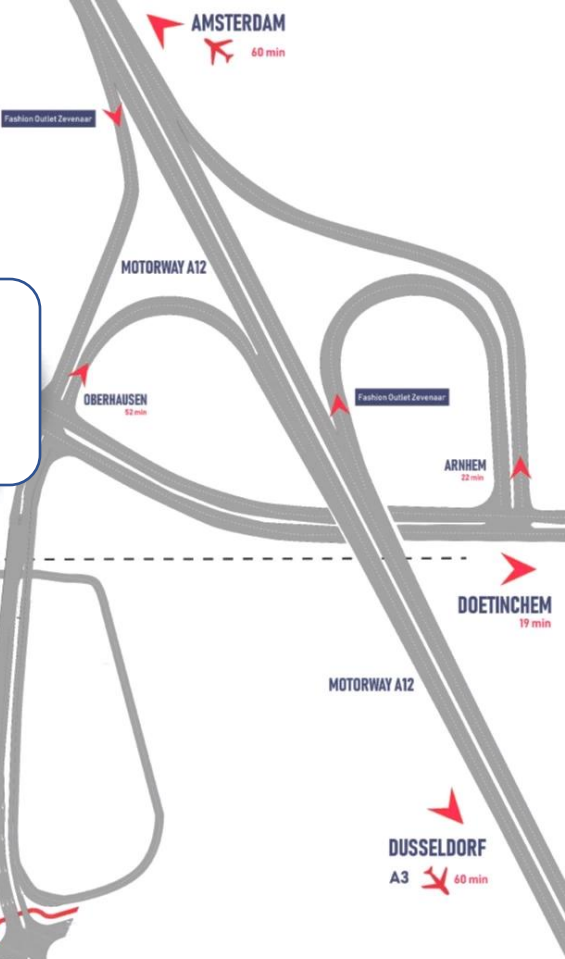

\*based on the new plan for the exit

# Overview parking areas

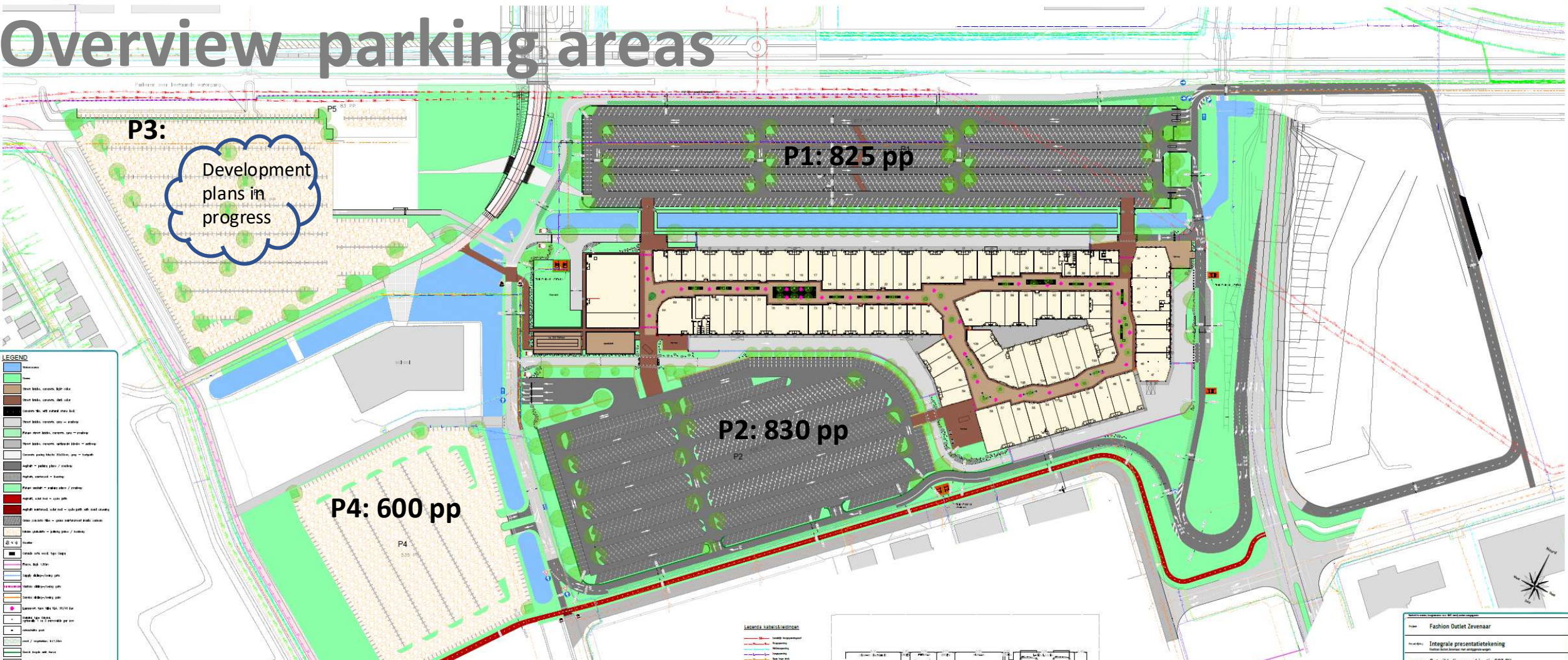



# Purchasing power of catchment

Total Purchasing Power (€bn) \*

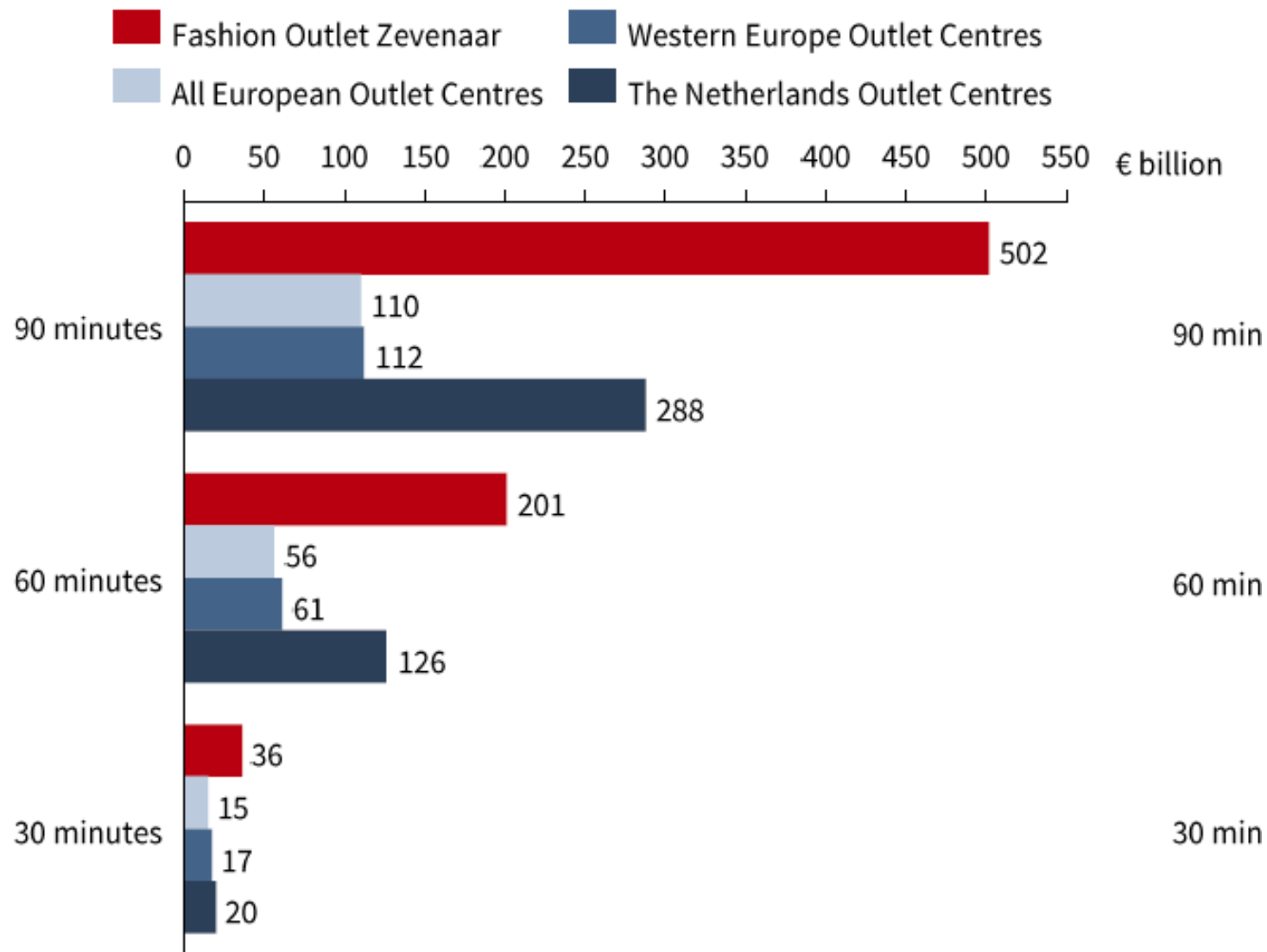

\*based on new A15





# The shop units perfectly designed For your brand

**Creating the ultimate shopping experience together.**

Easy accessibility, attractive surroundings, a variety of dining options and a wide selection of quality brands will make Fashion Outlet Zevenaar an unquestionable success with between 85 and 100 units available.

These units will be designed in the best possible way in depth, breadth and height to create the optimal sales environment.

The majority of units can be reached and supplied through a rear entrance due to the centre layout and comprehensive network of service roads. Temporary storage space is also available.



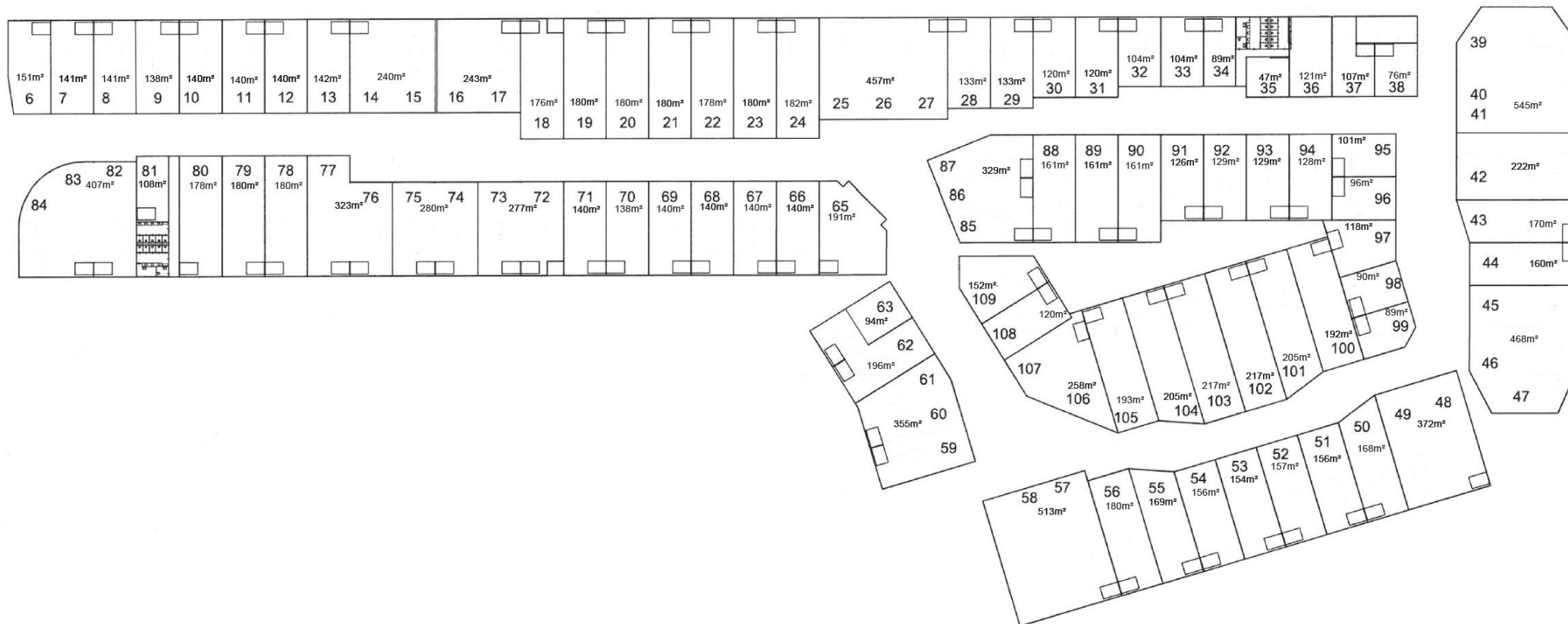
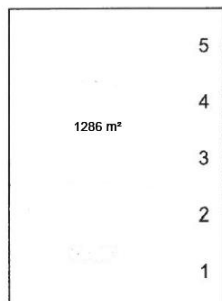

For internal use only!



## Excellent possibilities for expansion Phase II

### Pre-sorted for further growth in the future

The layout of phase 1 has already taken into account extensions in the near future. The most obvious option is to realize the extension on the parking lot. This creates a beautiful and logical routing. Parking garages can then be built on the three other parking areas, so that the lost parking spaces can be compensated, and many additional parking spaces can be realized.

The extensions including storage will amount approx. **20,000 m<sup>2</sup>**. The total project will be able to grow to approx. **40,000 m<sup>2</sup>**.

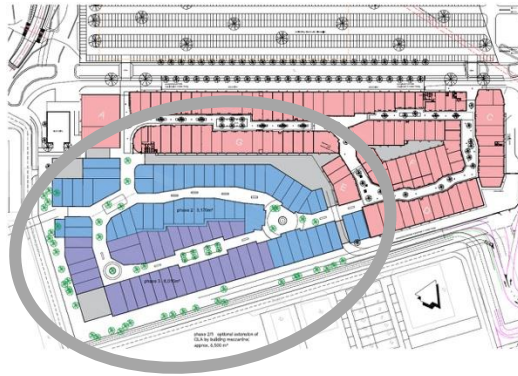

# Overnight stay with outlet view

## Hotel development

### Offering a wide range of facilities

In addition to the outlet, the planning for a hotel and leisure (food and entertainment) is in full development. The hotel and leisure have their own parking lot and are within walking distance for the visitor.

According to the current plans, the hotel will have approximately 120 rooms and approximately 1500 m<sup>2</sup> of leisure space is planned next to the hotel. Fashion Outlet Zevenaar can offer the consumer a wide range of facilities. It will be “the place to be” for the Dutch, the Germans and all other international visitors.





# Feel relaxed with happy Employees

## Cooperation between management and trainings institute ROC Rijn IJssel

Fashion Outlet Zevenaar and one of the largest schools/training institutes of the Netherlands, ROC Rijn IJssel signed an agreement for a close cooperation. This trainings institute will educate the students and the employees according to the latest insights, attuned to the needs of the work field.

ROC provides Fashion Outlet Zevenaar with personnel, the staff will be trained well and during the day trainers/teachers will coach them. Good and well motivated staff can be guaranteed. And we can achieve the highest possible level of service, in which everyone feels at home.

*"Very well-trained staff in the stores is most important. Visit an outlet is like a day out and an exceptional shopping experience with a high level of service. This partnership is therefore an excellent opportunity to strive from day one in a pleasant collaboration between our brand partners, the brands stores, the staff, the outlet management and ROC Rijn IJssel".*



# Eco-Friendly Sustainability



Gasless - no gas connections



Electric charging stations



PV cells on the roofs



Separate drainage



Separate waste streams



100% LED lighting



Only certified wood



Offering animal-friendly solutions



Indoor storage space. The number of traffic movements of trucks, among others, will considerably be reduced



A lot of green, trees, bushes, grasses included in the public areas and around the outlet



Energy-efficient climate control systems



Water collection and infiltration basins /Wadis



# No stress about Enough storage

## An extensive range of storage options

In and nearby Fashion Outlet Zevenaar are extremely well options for extra storage space. In the outlet there is a separated storage, perfect accessibility and also possible for short term lease. There are also two huge distribution centers with enough storage capacity, located at the other side of the road of the Outlet, max. 250 meters.

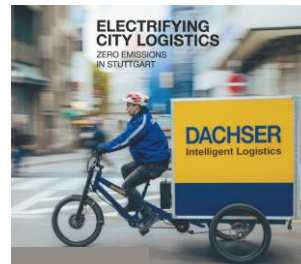



# Relax and shop in an Inspiring environment

## Relax in an inspiring environment

The immediate vicinity of the Fashion Outlet Zevenaar lends itself perfectly to an extended visit over several days. As well as a visit to Fashion Outlet Zevenaar, shoppers can treat themselves to an overnight stay in one of the attractive surrounding towns or our Fashion Outlet Hotel. The main attractions in the region are National Park Hoge Veluwe, Arnhem (city, Burgers' Zoo and Openlucht Museum) and Kröller Möller Museum. The big box retail park, next exit A12, in Duiven (5 million visitors) such as IKEA, MAKRO, LOODS 5, Media Markt, Intratuin and Hornbach is also very popular.

Marketing is targeted at both the Dutch audience as well as the key German market. A partnership has been agreed with the Regional Tourism Bureau for the Veluwe, Arnhem and Nijmegen, meaning the Outlet will be marketed in many different ways to a broad spectrum of potential (inter)national visitors.



Foto Jurjen Drenth i.s.m. Visit Arnhem Nijmegen



# That's why Fashion Outlet Zevenaar

- Perfect location next to the most important motorway/connection between the Netherlands and Germany (German border, a 4 min. drive)
- **The best catchment area of all European Outlets (90 min. drive)**
- **Top 10 ranking of best catchment area's of all European Outlets (60 min. drive)**
- Very interesting critical size 1st Phase
- Approx. 2,200 parking places (all within 5 minutes walking distance)
- 364 days open
- Very attractive architecture and perfect routing
- Cooperation with large education institute for employees and trainees
- Perfect possibilities for extra storage in the outlet or near by (250 m)
- Perfect possibilities for future expanding

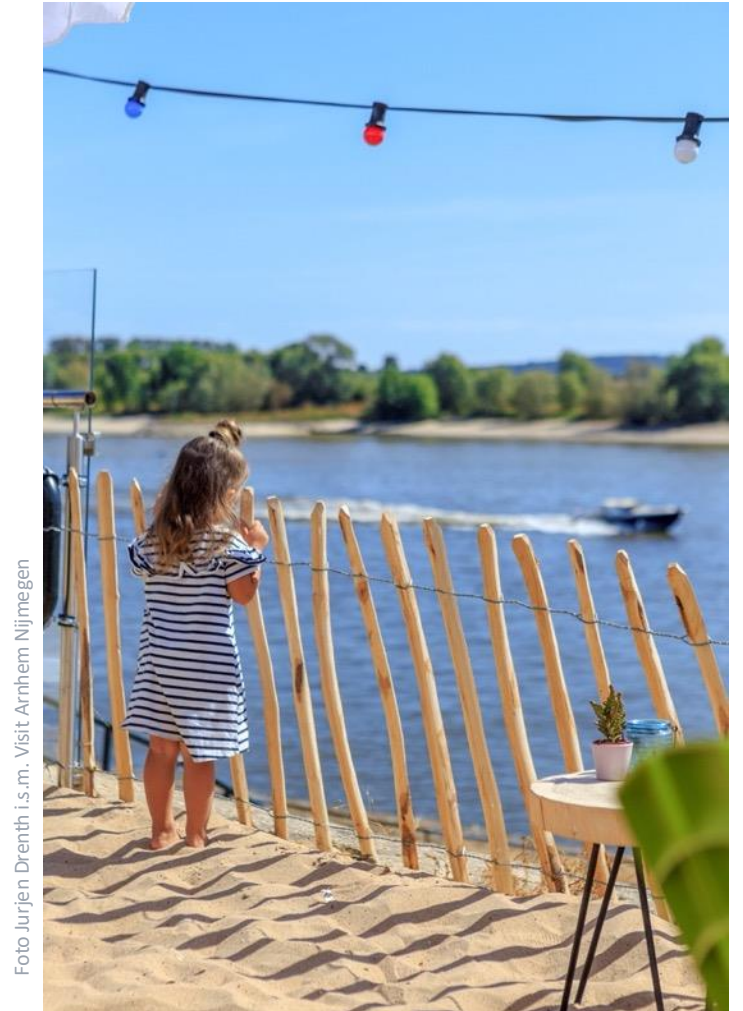



## Centres in Management

- Full Rental Management
- Part Rental Management
- Centre under Construction
- Centre in Planning

December 2024

**HASLINGER**  
RETAIL REAL ESTATE CONSULTING



# OUR PRESENCE

**15**  
Centres  
**4**  
Countries

**140,000 m<sup>2</sup>**  
Retail Space

**500**  
Shops

**Centres in Management**

- Full Rental Management
- Part Rental Management
- Centre under Construction  
Centre in Planning

December 2024

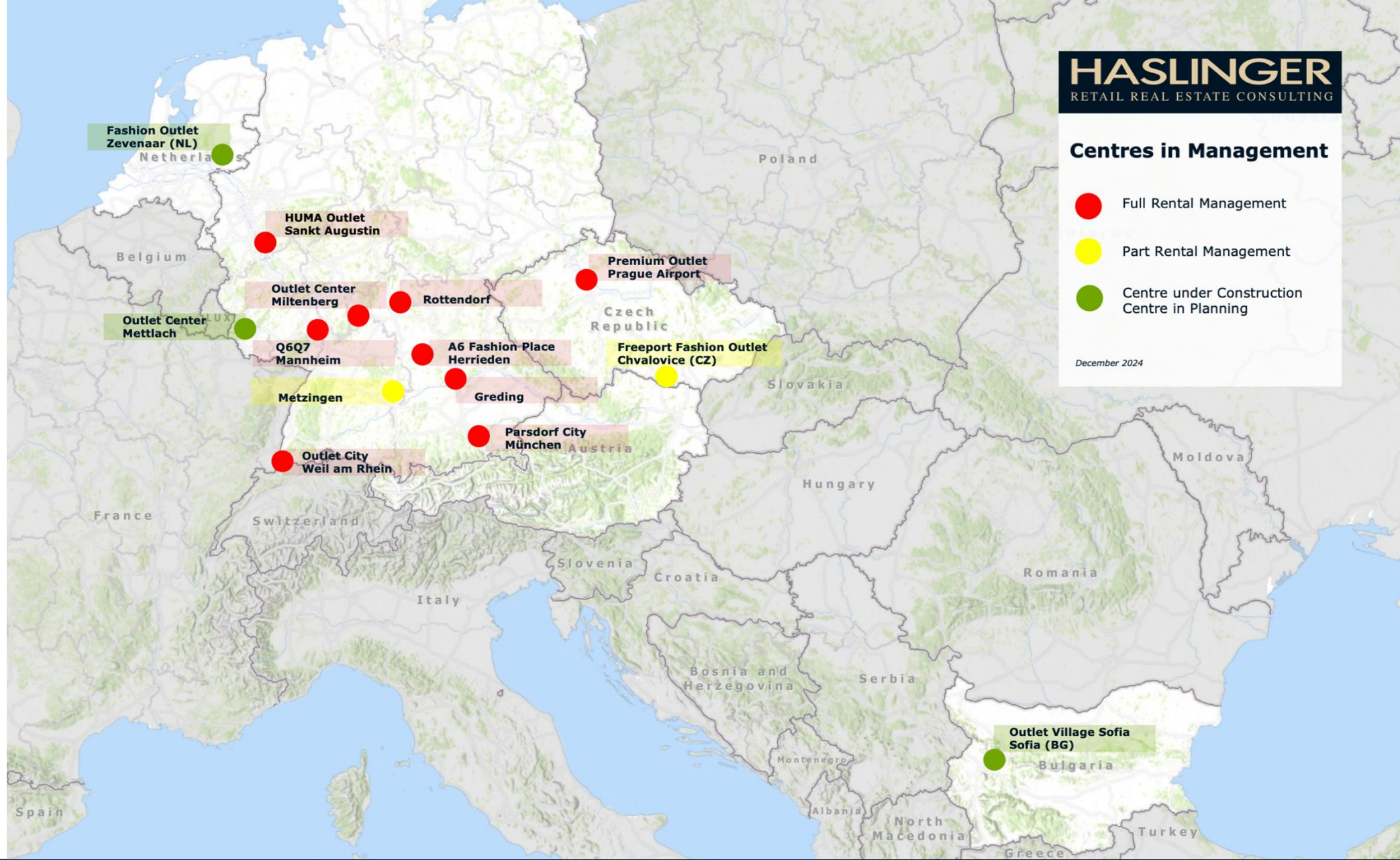

# OUR CENTERS



**HUMA**  
OUTLET



**OUTLET CITY**  
WEIL AM RHEIN



**fashion  
outlet**  
zevenaar

**POP**   
OUTLET & ENTERTAINMENT

**OUTLET**  
VILLAGE  
SOFIA



**FREEPORT**  
FASHION OUTLET

**Q 6 Q 7**  
Mannheim

DAS QUARTIER

**Parsdorf**  
city  
outlets+more

**MILTENBERGER**  
OUTLET // CENTER

**A6**

**FASHION PLACE**

# OUR REFERENCES

*Stadtgalerie Plauen • Rotmain Center Bayreuth • Franken Center Nürnberg • City Point Nürnberg • Stadtgalerie Heilbronn • Leo Center Leonberg • Saarpark Center Neunkirchen • Europa-Galerie Saarbrücken • The Colosseum Bucharest, RO • Drei Glocken Center Weinheim • Das Gerber Stuttgart • Designer Outlet Neumünster • Designer Outlet Berlin • Designer Outlet Roermond, NL • Designer Outlet Salzburg, AT • Designer Outlet Parndorf, AT • Designer Outlet Landquart, CH • Designer Outlet Soltau • Parndorf Fashion Outlet, AT • Outlet Center Brenner, IT • Outlet Noyon-Allee Metzingen • Galizia Center Metzingen • Outlet Center Moravia, CZ • Freeport, CZ • Outlet Center Hammerau • Outlet Center Drei Länder Galerie • Outlet Center Echternach, LU • Outlet Center Egelsbach Frankfurt a.M. • Outlet Center Jettingen-Scheppach • Klagefurt Outlets • Outlet Berlin Wustermark • Outlet Center Selb • Outlet Center Wadgassen • City Outlet Rietberg • City Outlet Dinkelsbühl • City Outlet Rüsselsheim • City Outlet Zwiesel • City Outlet Wernigerode • City Outlet Bad Münstereifel • Mustang • CBR Street One Cecil • Barutti • René Lezard • Le Creuset • Estée Lauder MAC Cosmetics • Apple mcworld, AT • LTB Jeans, TR • White Stuff, UK*





**MICHAEL  
HASLINGER**

CHAIRMAN OF THE BOARD

+49 172 83 68 297

m.haslinger@haslinger-immobilien.de



**NABILA  
GREMMINGER**

LEASING EXECUTIVE  
& SECRETARY

+49 176 5611 4390

n.gremminger@haslinger-immobilien.de



**KLAUS  
PREKER**

LEASING MANAGER  
& EXECUTIVE SEARCH

+49 151 465 36 845

k.preker@haslinger-immobilien.de



**SABINE  
HASLINGER**

FINANCE MANAGER

+49 172 21 28 409

sh@haslinger-immobilien.de



**MATTHIAS  
DÜRR**

DIRECTOR OF OPERATIONS

+49 177 77 32 222

m.duerr@haslinger-management.de



**EVELIN  
TOPCU**

MARKETING & IT/AI  
PROCESS MANAGER

+49 172 35 56 805

e.topcu@haslinger-immobilien.de



**ESENGÜL  
KAHRAMAN**

RETAIL MANAGER

+49 155 61 69 44 14

e.kahraman@haslinger-management.de



**PETER  
KULAWIAK**

CONTENT MARKETING  
CREATOR

+49 155 61 93 03 38

p.kulawiak@haslinger-management.de



**LOUISA  
SCORY**

JUNIOR MARKETING  
MANAGER

+49 155 61 36 32 66

l.scory@haslinger-management.de

# COPYRIGHT

The entire content of this presentation may not be reproduced, processed or distributed.

The contents are intended for internal use only, publication is strictly prohibited.

Passing on the contents of the presentation requires the written consent of HASLINGER RETAIL REAL ESTATE CONSULTING.

# HASLINGER

RETAIL REAL ESTATE CONSULTING

*Successfully in business for over 10 years!*

# HASLINGER

MANAGEMENT